

NOV. 22, 2011 6:25 PM HARR010115 I:\100088\10A0088\CAD\AIRPORT_SHEET\EXHIBITS EAST - SOUTH SIDE.DWG

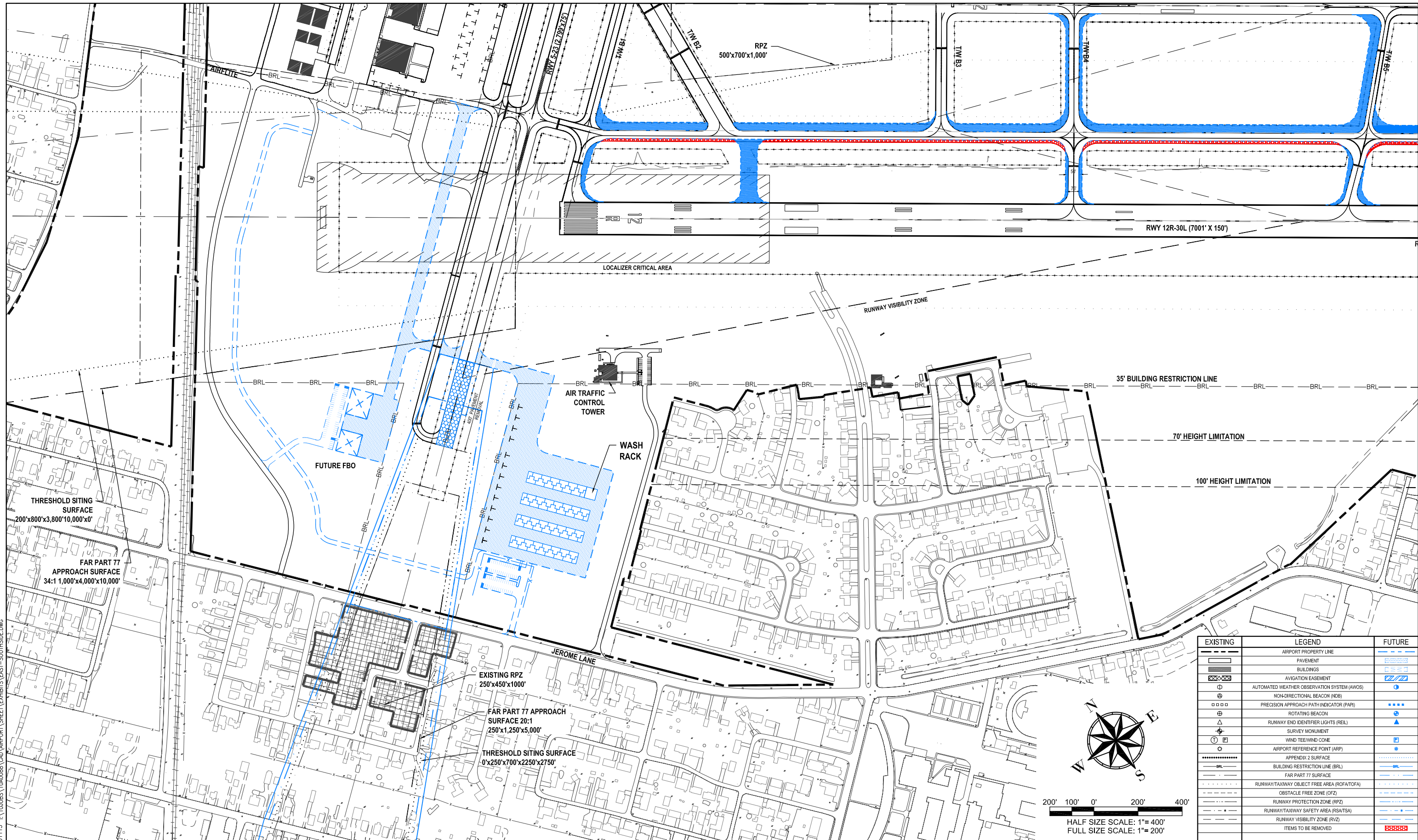

EXISTING	LEGEND	FUTURE
---	AIRPORT PROPERTY LINE	---
▭	PAVEMENT	▭
▭	BUILDINGS	▭
▭	AVIGATION EASEMENT	▭
⊙	AUTOMATED WEATHER OBSERVATION SYSTEM (AWOS)	⊙
⊙	NON-DIRECTIONAL BEACON (NDB)	⊙
⊙	PRECISION APPROACH PATH INDICATOR (PAPI)	⊙
⊙	ROTATING BEACON	⊙
⊙	RUNWAY END IDENTIFIER LIGHTS (REL)	⊙
⊙	SURVEY MONUMENT	⊙
⊙	WIND TEE/WIND CONE	⊙
⊙	AIRPORT REFERENCE POINT (ARP)	⊙
⊙	APPENDIX 2 SURFACE	⊙
---	BUILDING RESTRICTION LINE (BRL)	---
---	FAR PART 77 SURFACE	---
---	RUNWAY/TAXIWAY OBJECT FREE AREA (ROFAT/OFA)	---
---	OBSTACLE FREE ZONE (OFZ)	---
---	RUNWAY PROTECTION ZONE (RPZ)	---
---	RUNWAY/TAXIWAY SAFETY AREA (RTSA/TA)	---
---	RUNWAY VISIBILITY ZONE (RVZ)	---
---	ITEMS TO BE REMOVED	---

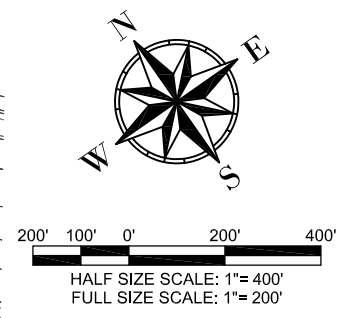

DATE	REVISION



HANSON PROJECT	10A0088
DATE	
SCALE	1"=200'
LAYOUT	
DRAWN	
REVIEWED	



WEST/SOUTHWEST AIRPORT DEVELOPMENT
LAND USE MASTER PLAN
ST. LOUIS DOWNTOWN AIRPORT
CAHOKIA, ST. CLAIR COUNTY, ILLINOIS

EXHIBIT 3-8