

200' 100' 0' 200' 400'
 HALF SIZE SCALE: 1"= 400'
 FULL SIZE SCALE: 1"= 200'

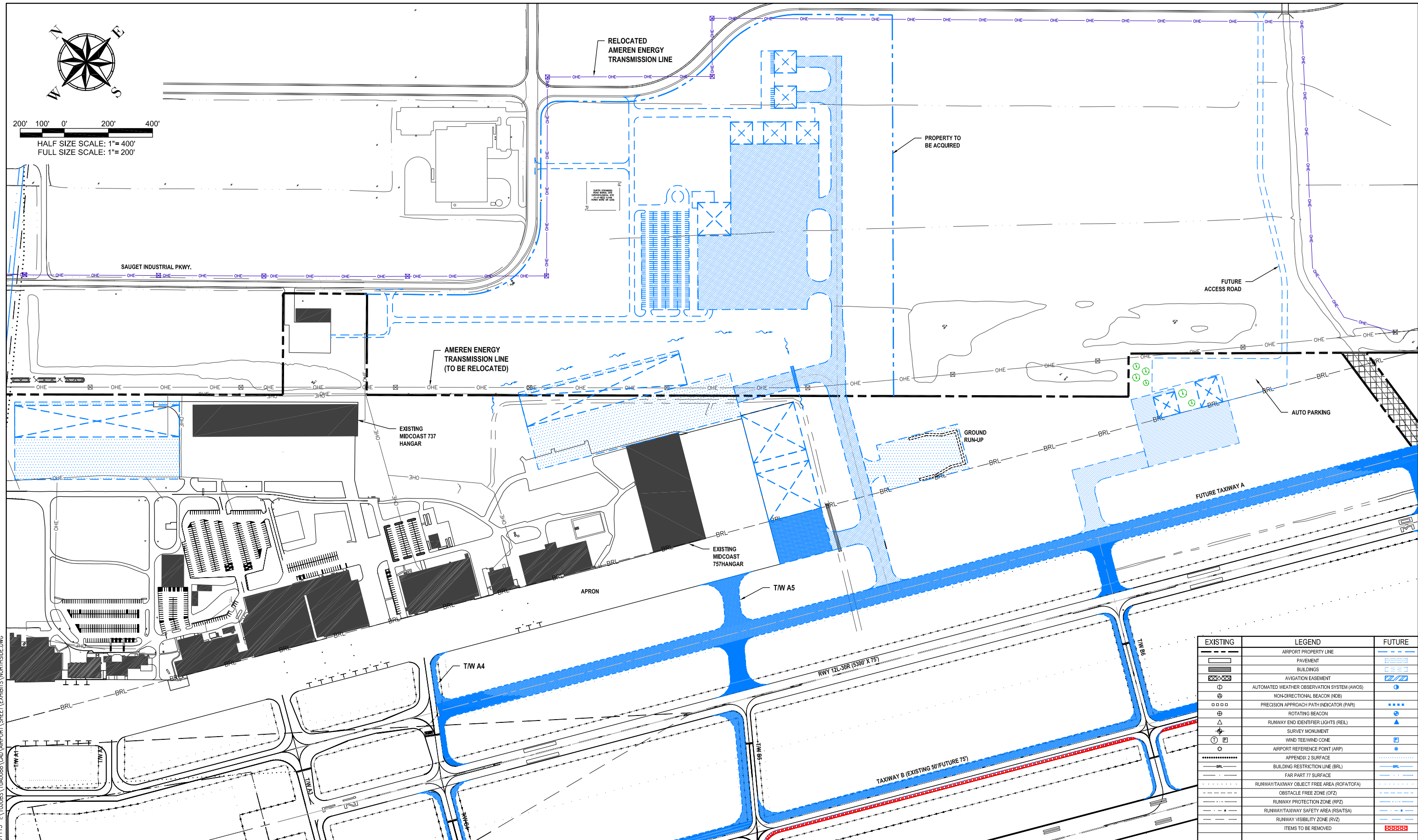

EXISTING	LEGEND	FUTURE
---	AIRPORT PROPERTY LINE	---
---	PAVEMENT	---
---	BUILDINGS	---
---	AVIGATION EASEMENT	---
⊙	AUTOMATED WEATHER OBSERVATION SYSTEM (AWOS)	⊙
⊙	NON-DIRECTIONAL BEACON (NDB)	⊙
⊙	PRECISION APPROACH PATH INDICATOR (PAPI)	⊙
⊙	ROTATING BEACON	⊙
⊙	RUNWAY END IDENTIFIER LIGHTS (REL)	⊙
⊙	SURVEY MONUMENT	⊙
⊙	WIND TEE/WIND CONE	⊙
⊙	AIRPORT REFERENCE POINT (ARP)	⊙
---	APPENDIX 2 SURFACE	---
---	BUILDING RESTRICTION LINE (BRL)	---
---	FAR PART 77 SURFACE	---
---	RUNWAY/TAXIWAY OBJECT FREE AREA (ROFAT/OFA)	---
---	OBSTACLE FREE ZONE (OFZ)	---
---	RUNWAY PROTECTION ZONE (RPZ)	---
---	RUNWAY/TAXIWAY SAFETY AREA (RTSA/TA)	---
---	RUNWAY VISIBILITY ZONE (RVZ)	---
---	ITEMS TO BE REMOVED	---

NOV. 22, 2011 5:36 PM HARR01115 I:\104088\104088\CAD\AIRPORT_SHEET\EXHIBITS_NORTHSIDE.DWG

DATE	REVISION



**SAINT LOUIS
 DOWNTOWN AIRPORT**
 A Division of METRO

HANSON PROJECT	10A0088
DATE	---
SCALE	1"=200'
LAYOUT	
DRAWN	
REVIEWED	

HANSON
 Hanson Professional Services Inc.
 1525 South Sixth Street
 Springfield, Illinois 62703
 Offices Nationwide www.hanson-inc.com

NORTH SIDE AIRPORT DEVELOPMENT
LAND USE MASTER PLAN
ST. LOUIS DOWNTOWN AIRPORT
CAHOKIA, ST. CLAIR COUNTY, ILLINOIS

**EXHIBIT
 3-7**